



**APPLICATIONS FOR FUNDING FROM THE AUCHTERARDER  
COMMUNITY FACILITIES FUND**

**GUIDANCE NOTES FOR APPLICANTS AND APPLICATIONS FORM**

## **BACKGROUND**

The Auchterarder Development Framework will deliver 800 dwelling houses within Auchterarder. The identified level of development will have an impact on the level of existing services provision provided by community facilities. To mitigate this impact as the development progresses a contribution of £1,000 per unit will be made up to a total £600,000. This money will be used by the Council over the lifetime of the development to improve the wider realm or facilities as the demand on these increases. The Auchterarder Community Facilities Fund will be available for use on projects being promoted by Council Services and voluntary/community organisations which improve the amenity of the public realm or facilities within the settlement boundary of Auchterarder.

## **GUIDANCE NOTES**

The Council will consider all applications for funding in line with the essential criteria. Where it is agreed the proposal would support community projects and meet the essential criteria the Executive Director (Environment) can approve the transfer of contributions up to a maximum of £50,000 per project. Applications for funding for more than £50,000 per project will require Committee approval. Where Committee approval is required this may take up to 4 months, dependant on the Committee cycle.

All contributions received will be spent on projects which improve the amenity of the public realm or facilities within the settlement boundary of Auchterarder. These include, but not exclusively, car parking facilities, public hall improvements, adaption of existing school changing facilities to permit access to pitches forming part of the new Sports Facilities, a public library, new or enhanced public transport services, improvements to the core path network and recycling facilities. This range of community improvements forms the basis of the criteria against which applications for funding from the fund will be assessed.

The funding will not be received by the Council as a lump sum, but will be based upon the sales of each new dwelling within the Development Framework; therefore funds will only be allocated to projects where they have already been collected. The funding will not be used to fund a single large project, but will be spread across a range of projects. A report providing details of funding received and allocated will be published annually in April.

### **Who can apply?**

The Auchterarder Community Fund is available for use on projects being promoted by Council Services and voluntary/community organisations. The definition of a voluntary/community organisation is a body which is led by volunteers, is non-profit distribution, legally independent of the state, and is dedicated to a public good. The funding criteria contained in this guide apply to all local voluntary/community and national voluntary organisations and umbrella organisations requesting financial support from the Auchterarder Community Fund. Applicant organisations would have to demonstrate that they are open to all regardless of religion, race, gender or disability.

### **Specific Notes:**

- Religious organisations: religious organisations will be considered, if they meet the standard conditions, on the basis that the programme offered is sufficiently general in nature to be applicable to a wide cross-section of the population of regular and sufficient duration (eg weekly for 2 hours, 36 weeks per year).
- Uniformed organisations: Uniformed organisations can apply where there is provision within a written constitution for equal access and opportunity for individuals as appropriate to the nature of the organisation.

- National organisations: National organisations will be considered, if they are able to identify defined local activities to the reasonable satisfaction of the Council.

### **Criteria For Assessing Applications For Funding**

Applications for funding should meet the following criteria:

1. Projects should be located within the settlement boundary of Auchterarder as defined by the adopted Local Development Plan. Projects which start within the boundary but extend out with, such as core path improvements, would be acceptable;
2. Projects should be linked to mitigating the impact of the new housing within the scope of the Auchterarder Development Framework on the public realm or facilities;
3. Projects should improve the amenity of the public realm or facilities and should consider a range of funding streams in addition to the Community Facilities Fund to ensure maximum value. Money cannot be used for projects which are already fully funded from other sources. Projects being brought forward with contributions from other funding streams will be able to access gap funding from the Community Facilities Fund.
4. Projects should identify any ongoing maintenance or eventual replacement costs and demonstrate that this can be secured through existing or future budgets.

### **APPLICATION FOR FUNDING**

In order to minimise delays in processing your application please complete all sections as fully as possible. Plans and or information can be attached in support of the application form.

Name of applicant(s) (to whom funding would be payable)

Auchterarder Community Sport & Recreation (ACSR) SC048490

Project address/location (please attach a location plan)

Public (Victoria) Park, Western Road, Auchterarder PH3 1JG

#### **Project proposal overview**

Please see attached plans which Steven Kane, P&K Community Green Spaces, which were submitted for Planning Permission in November 2020.

The Project is to redevelop the whole of Auchterarder Public (Victoria) Park to include removal of current play equipment and surfaces and the addition of new multisensory play equipment which will include swings, roundabout, zip wire, climber, slide, springie, seesaw, inclusive DDA compliant play items (trampoline, wheelchair seesaw, spinmee).

In addition, there will be natural play tunnels, log steps and sports fitness equipment, new goals and basketball nets. To prepare for all of the new items, there will be drainage works, re-surfacing, paving, edging and to improve the overall park aesthetics, turfing, seeding and shrubbery..

The redevelopment plan also includes improvements to the circular walking path and extension to the skatepark, in addition to providing a Mountain Bike Trail and Pump Track.

ACSR - Park & Community Green Spaces WG, in partnership with P&KCGS, began this process in November 2017 with a Community Consultation. This was followed by a Feasibility Study carried out during 2018, a second Community Consultation in early 2019 and Final Plans shared in March and confirmed in September 2020.

The Park has safe links to the Provost Walk and ACSR plan to work with PKC to improve Parking and provide safe access to and from the Auchterarder Primrose FC Pavilion.

Due to Covid-19, the park development project has been delayed by approximately twelve months, however with funding the project can be realised by October 2021.

#### **Project output** (What is the project seeking to achieve?)

The aim is for Auchterarder Public Park to become a 'Destination' for all ages and abilities within our community. As Auchterarder continues to expand and our population continues to increase, it is important that local facilities keep up with demand. During CV-19, the Park, Provost Walk and Core Path network have all been invaluable assets and have seen between 300% - 400% increase in use.

The Scottish Government Rural Youth Survey (2018) highlights the need for the provision of good local facilities within rural communities, as often younger residents have access to limited public transport and therefore fewer opportunities and facilities within easy reach, compared to those living in more urban areas.

This can sadly be true for some young people during their teenage years, as it has been shown that not being able to access positive outlets for their energy, can lead to varying forms of anti-social behaviour and potentially drugs. The more activities and opportunities

available within our community the less likely this will happen. Not all young people enjoy formal sport and are more interested in physical activities that provide more personal challenges such as mountain biking and skateboarding, with a pump track for scooters, balance bikes and BMX that cater for ages and include families activities.

The redevelopment of the Park, will entice all ages and abilities to use the excellent and thrilling new play/recreation areas, encouraging individuals and families to return multiple times.

The more often people come to any park, the higher the likelihood they will meet an increasing number of their neighbours. When people interact with each other, they create friendships that, in turn, form the basis of a strong community.

In addition, any individuals or families, who are new to the area, will have an opportunity to bond into a collective with the aims of helping their neighbours and their community. This type of outdoor interaction will have the positive benefit of leading to higher levels of community wellbeing and this outcome could not be more needed during and beyond the Covid-19 pandemic.

Just being outside and being active has positive effects on mental and physical wellbeing and ACSR in partnership with PKC wish to provide a redeveloped community Park that excites people of all ages and provides a much improved location for all to gather.

We hope, this will also encourage those who live out with the area to make repeat visits and in time be an attractive stop for tourists to park and visit the town by using the Provost Walk.

ACSR aim to ensure that the Community Area within the Pavilion, will become an important 'Hub' for information and activities within the Park and community, in addition to hopefully becoming a 'Pop Up' Café on Match Days.

As Auchterarder continues to grow and once our new Development Officer is in place, ACSR will continue to work with our Clubs, schools and community organisations to establish a full Programme of activities linked with Auchterarder Park.

Amount of funding requested **£100,000.00**

#### **Details of what the funding will be spent on**

The total project cost is - £356,914 (including £88,414 in disability equipment costs). Please see the attached spreadsheet for itemised costs. We are seeking funding from a variety of sources to realise our project, as follows

PKC £150,000 - confirmed

ACSR £18,500 - confirmed

Auchterarder Community Facilities Fund £100,000 - herein

Auchterarder Common Good Fund £30,000 - application in progress (disability focus)

Friends of St. Margaret's £30,000 - application in progress (disability focus)

Bank of Scotland Reach Funding - £24,510 - application in progress (disability focus)

Securing £100,000.00 from the Auchterarder Communities Facilities Fund will greatly support our other funding applications.

ACSR – Parks WG hope to be able to fund other ‘extras’ eg pump track, extension to the skateboard area, lighting & safe access to the Pavilion. but these may require a phased approach as and when funds become available.

Pump track - total estimated £100,000 - £120,000

sportscotland cycling fund £50-60k – Expression of Interest submitted December 2020  
Match funding from Gannochy Trust £50-60 – Application to be submitted early 2020

Summary of any other funding sources which will be used in addition to requested funding

Please see details above.

Date by which receipt of funding is preferred

Planning Permission was submitted to PKC at the beginning of **November 2020**

Aim for all ‘pledged’ funding to be in place by **28<sup>th</sup> February 2021**

PKB CGS to begin Tendering process **March 2021**

Construction to take place between – July – September 2021

Payment due to ACSR/PKC by **September 30<sup>th</sup> 2021**

Park Completion and official opening October 2021 TCB

Applications for less than £50,000 will normally be decided within 6 weeks but if an earlier decision is required please indicate the date below. Applications for more than £50,000 will require Committee approval which may take up to 4 months.

28<sup>th</sup> February 2021 please see above schedule.

For all applications a **location plan** of the project site should be submitted with the application.

Applications should be preferably be submitted by email to the Developer Negotiator at [TESDevelopmentContributions@pkc.gov.uk](mailto:TESDevelopmentContributions@pkc.gov.uk)

A paper copy of the application together with the accompanying location plan should be sent for the attention of the Developer Negotiator to:

Strategy & Policy Planning  
Perth & Kinross Council  
Pullar House  
35 Kinnoull Street  
Perth, Ph1 5GD

## Auchterarder Community Facilities Fund

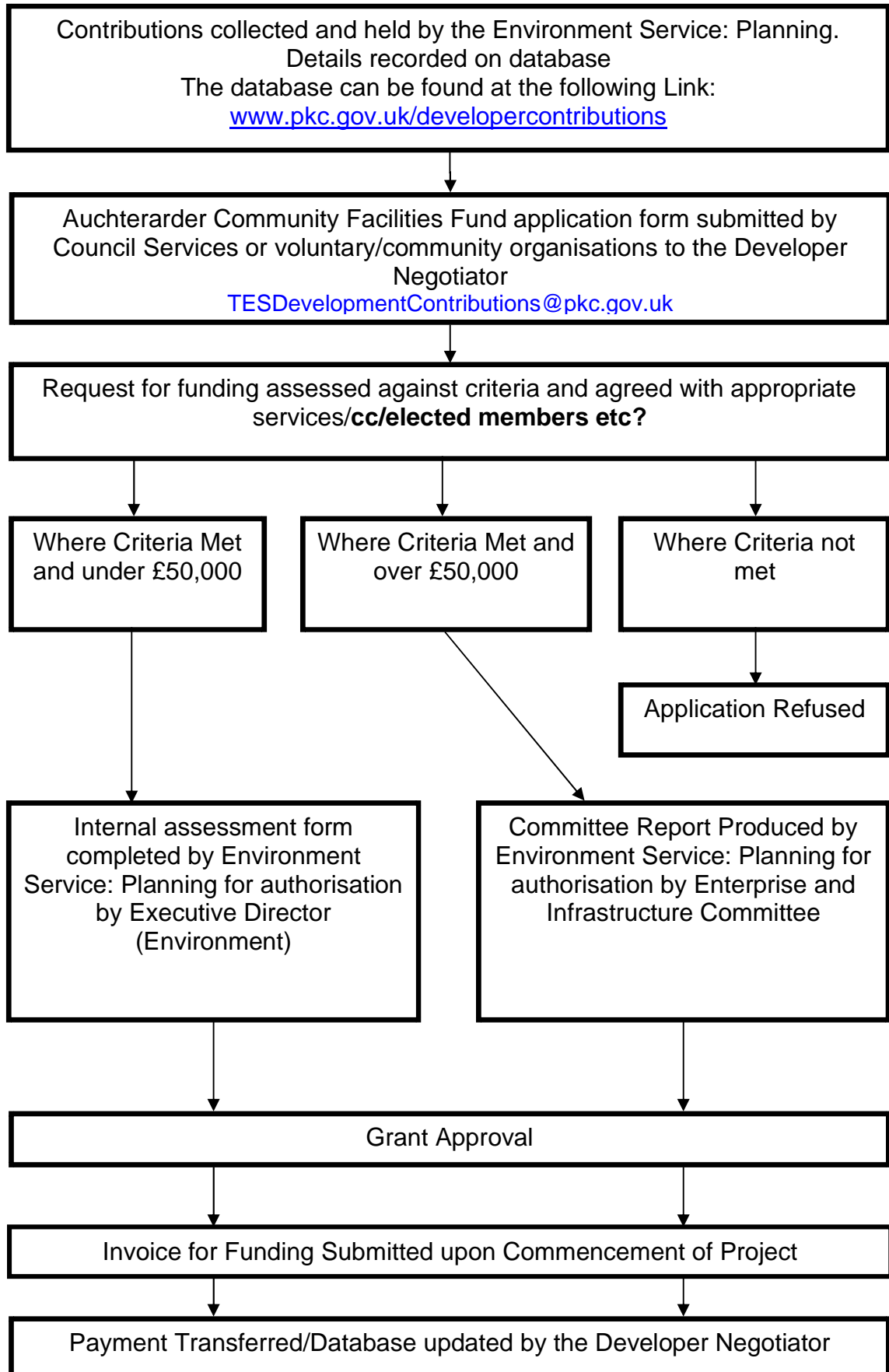

# AUCHTERADER PUBLIC PARK - FINAL PROPOSAL

**ENTRY**  
Possible re-open park entrance with new staggered entrance / pedestrian barrier or fill in with stone wall and remove path.

**PUMP TRACK**  
Possible small pump track with a grassy section and sections edged with asphalt.

**EXISTING PLAY AREA**  
Possible re-open and "renovate" area grassed.



**PATH**  
Paths to be lifted to removed public.

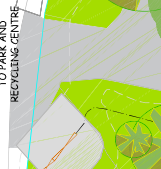
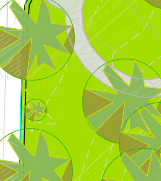
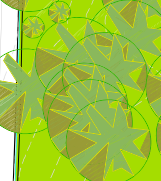
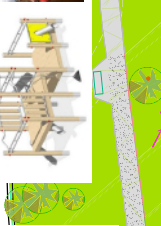

## AUCHTERADER PUBLIC PARK - OVERALL PLAN

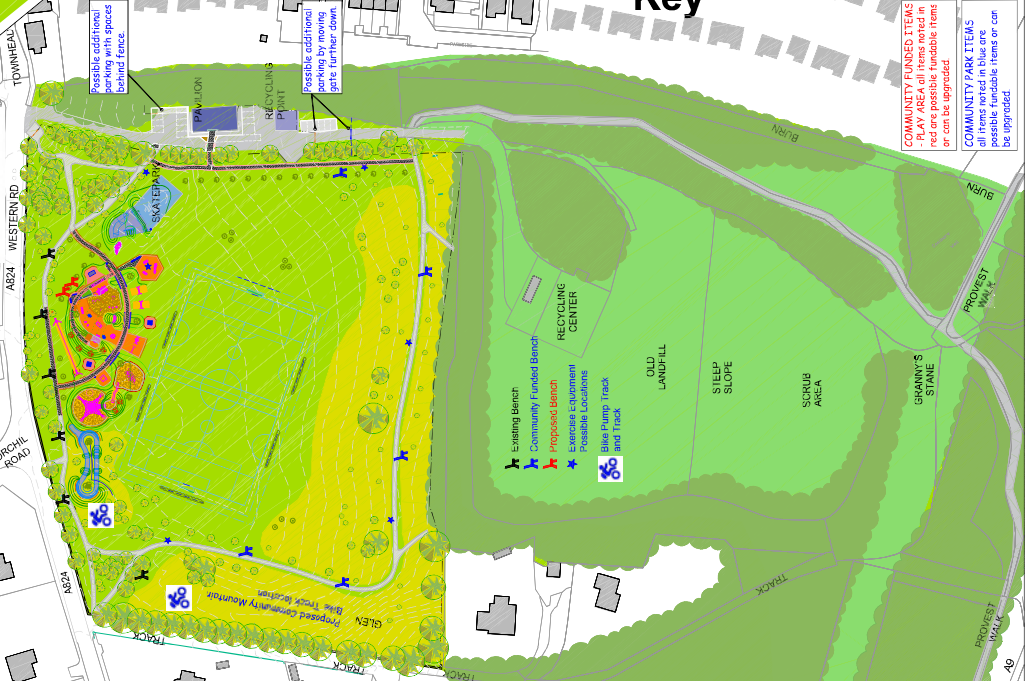

Possible additional parking with spaces behind fence.

Possible additional parking by moving gate further down.

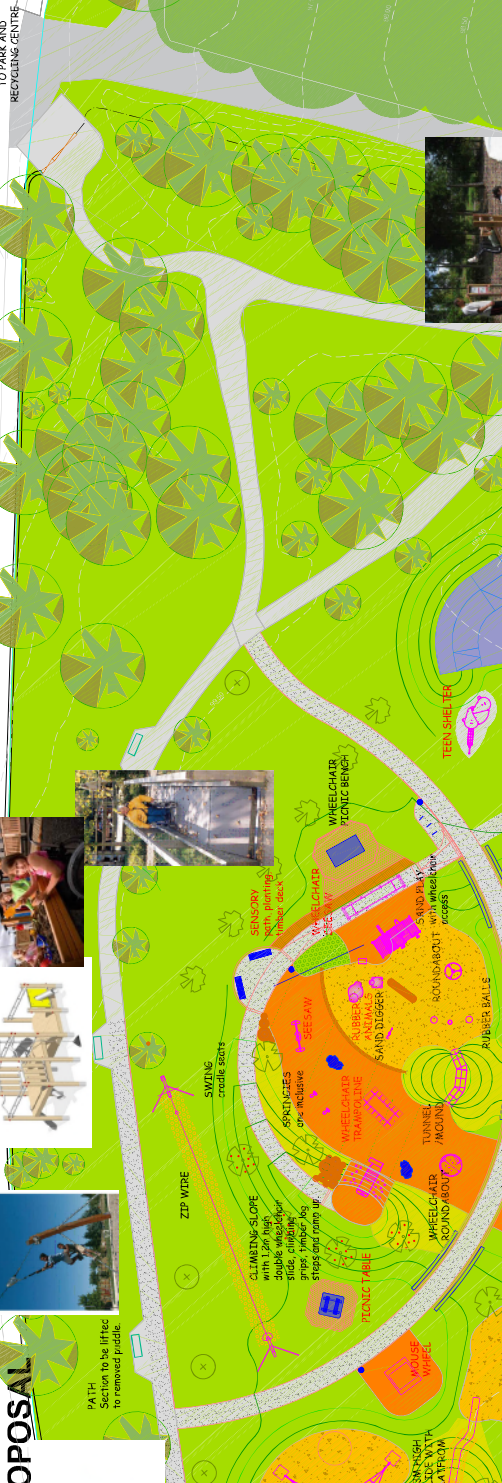

**AB24 WESTERN RD**  
**PARK ROAD ACCESS TO PARK AND RECYCLING CENTRE**

**EXISTING SKATEPARK**  
**POSSIBLE EXTEND SKATEPARK**  
**TIMBER EXERCISE STATIONS**  
**POSSIBLE CIRCULAR LINK PATH**  
**REMOVE SMALL TREES IN POOR CONDITION AND REPLANT**  
**POSSIBLE CIRCULAR LINK PATH**

**PAVILION**  
Surfacing to be surface parking, narrow roadway to be wide, planting, market parking etc extended.  
Surfacing to be building to allow access wheelchair comp.

**RECYCLING POINT**  
**RECYCLING CENTRE**  
**ADDITIONAL PARKING**  
**POSSIBLE EXTEND SKATEPARK**  
**POSSIBLE CIRCULAR LINK PATH**



Community Funded Items - PLAY AREA all items noted in red are possible fundable items or can be legnded.  
Community Park Items - all items noted in blue are possible fundable items or can be legnded.

Item	Color
Existing Bench	Green
Community Funded Bench	Blue
Proposed Bench	Red
Exercise equipment	Blue
Possible Locations	Blue
Bike Pump Track	Blue

Item	Color
Parking lines	Grey
Proposed Wheelchair path	Orange
Existing Tar Path	Green
Proposed Tar Path	Blue
Tagallé Sets	Blue
Proposed Trees	Green
Proposed fruit trees	Green
Existing Trees	Green
Proposed timber exercise stations	Blue

Item	Color
Standard safety surfacing	Orange
Rubber Grass Mat	Green
Existing Benches	Green
Proposed Benches	Blue
Proposed bins	Blue
Proposed Picnic Benches	Blue
Proposed timber exercise stations	Blue

**OVERALL**  
Proposed paths with fence linear setbacks. Fly between roads up and over to each area. Consulting with this large climber rope wound.

**FOOTBALL PITCH**  
Men pitch 5000m. Possible additional fencing to rear of path or willow line.

**PITCH**  
Contours are green for proposed set at 250mm park. Slopes are mostly 1:4 with smooth grading into a tunnel and slick to be left as usage expected to control.

**Play Area**  
Play is to be set with the linear fences across. Fences to be set behind the main pitch goals and to be designed by others, verified within track and play area. (See plan sheet for control fence).

**AREA RETAINED FOR POSSIBLE FUTURE W/CA**  
Space only shown as indication of future space retention.

## Key

Item	Color
Existing Bench	Green
Community Funded Bench	Blue
Proposed Bench	Red
Exercise equipment	Blue
Possible Locations	Blue
Bike Pump Track	Blue

Community Funded Items - PLAY AREA all items noted in red are possible fundable items or can be legnded.  
Community Park Items - all items noted in blue are possible fundable items or can be legnded.

FINAL PROPOSALS	
Project	Auchterader Public Park
Client	City of Edinburgh Council
Design	SK



**PROGRAMME**  
**7078 Auctherarder Public Park Project**  
**2020 09 29 rev F**

