

Rev	Description	By	Date	Chk'd	Approved	Purpose of Issue	Client
T.3	Supplementary service information added on OER	TAH	22/06/21	RC	22/06/21	The Road Hump/Scotland Reg. consultation	Perth and Kinross COUNTRYSIDE TRUST
T.2	Dimensions revised on Old Edinburgh Road table details	TAH	15/06/21	RC	15/06/21	The Road Hump/Scotland Reg. consultation	
T	Tender Issue	TAH	25/02/21	RC	25/02/21		TP&E Transport Planning & Engineering
A	Original Drawing						

Project		Bridge of Earn to Newburgh Phase 1A	
Title		Proposed Road Layout Preliminaries – General Work Content	
Scale	1:200	Drawn	TAH
Date	09/06/20	Checked	RC
Date	22/12/20	Approved	RC
Date	22/12/20	Approved	RC
Drawing No.	777_TPE_V1_XX_DR_C_0111		Rev
			T.3

Reproduced by permission of Ordnance Survey® on behalf of HMSO. © Crown Copyright and database right 2020. All Rights Reserved.
 Ordnance Survey® Licence number 100016971 EUL 2020, Perth and Kinross Council. You are permitted to use this data solely to enable you to respond to, or interact with the organisation that provided you with the data. You are not permitted to copy, sub-licence, distribute or sell any of this data to third parties in any form.

Existing Kerb line, height varies retain min of 5mm max 35mm of kerb upstand to assist drainage.

Saw cut to existing wearing course depth

Saw cut to existing wearing course depth

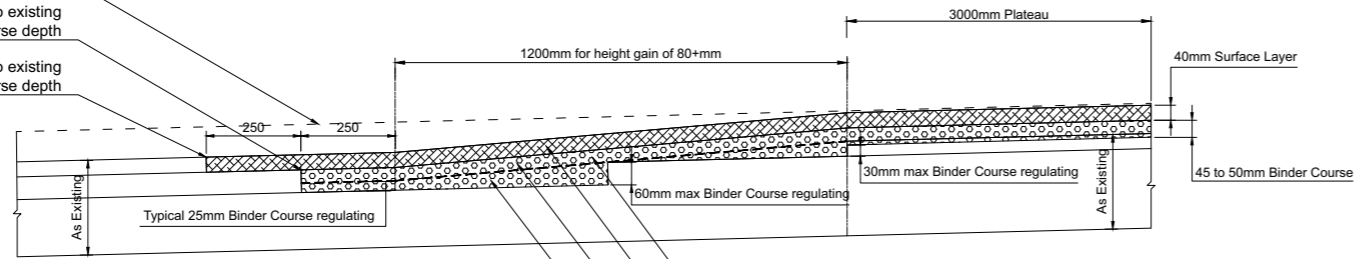

Locally plane out existing surface and binder layers within ramp area. Saw cut all vertical faces.

AC10 surf 100 / 150 30mm deep layer. Red thermo-plastic surface layer to be added to highlight sloped area.

New AC20 dense bin 40 / 60 base course varying depth, 45mm desirable with binder course regulating to match existing

binder course regulating

Series 700 Section A-A: A912 side of table ramp details

Notes:

- Do not scale from this drawing.
- All dimensions are in Millimetres.
- Markings to diagram 1062 of TSRGD
- Plateau sections of speed tables shall be 3m in length.
- Road Centre-line markings to diagram 1004 shall be provided over the ramp
- Tables on cambered roads shall match the profile of the underlying road surface.
- Ramp from A912 approach to be surface dressed with a red thermo-plastic screed material.
- Ramp from Old Edinburgh Road approach side to be formed as an overlay / inlay tie-in into the existing carriageway using surface and base layer construction as per ramp detail in Section A-A. Final carriageway level to provide a smooth tie-in profile to the table top extending the existing hill gradients over a distance varying from a minimum of 2.2m to approx. 3.6m. (see drawing 777_TPE_V1_XX_DR_C_0722)

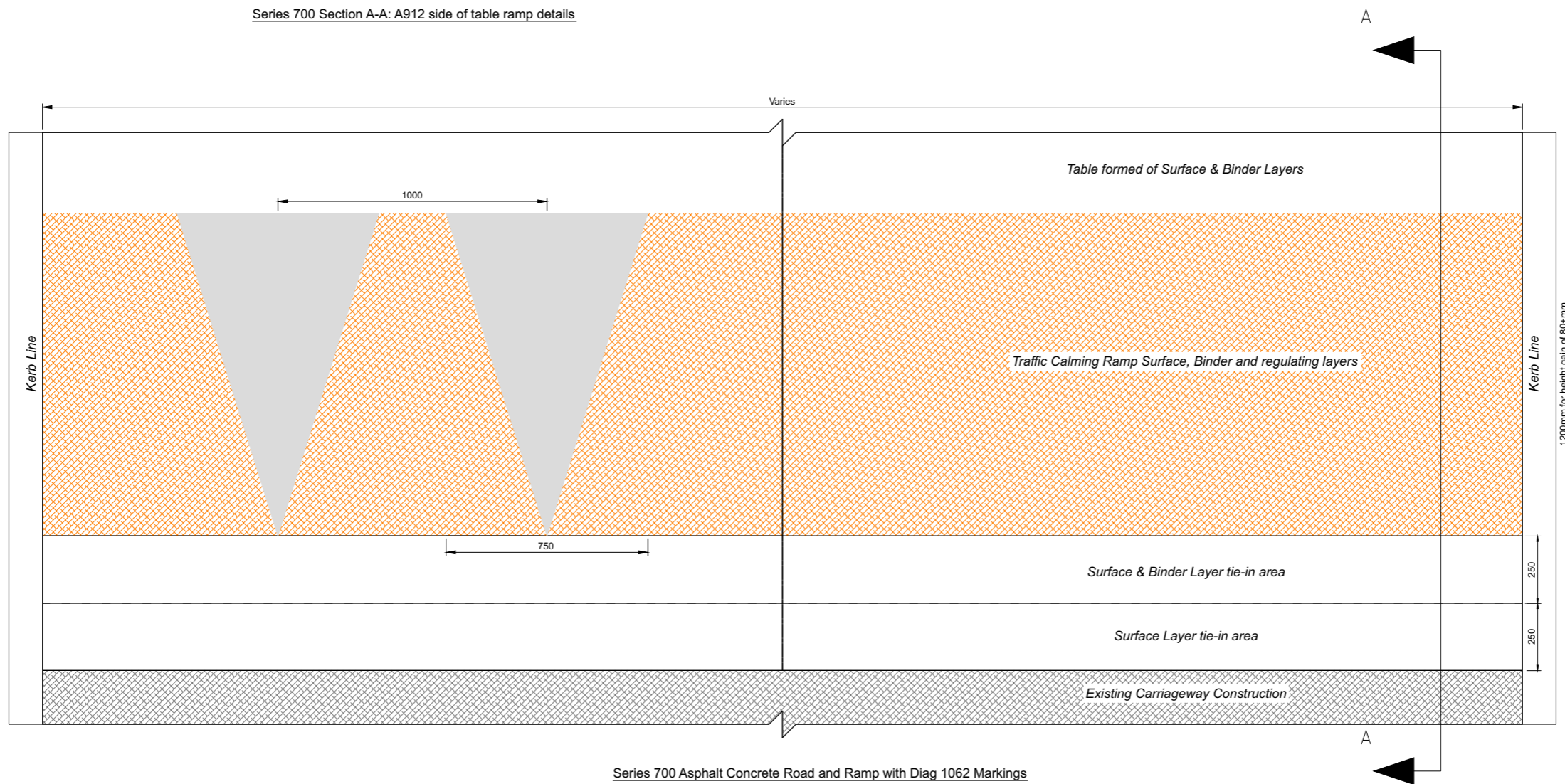

Series 700 Asphalt Concrete Road and Ramp with Diag 1062 Markings

Notes :

Rev	Description	By	Date	Chk'd	Approved	Purpose of Issue
T.3	Supplementary service information added on DER	TAH	22/06/21	RC	22/06/21	The Road Works/Scotland Reg. consultation
T.2	Notes updated to include Old Edinburgh Road variation	TAH	15/06/21	RC	15/06/21	The Road Works/Scotland Reg. consultation
T	Tender Issue	TAH	25/02/21	RC	25/02/21	
A	Original Drawing					



Project		Bridge of Earn to Newburgh Phase 1A	
Title		Drawing 1 of 1 Road Pavements General – Table Construction	
Scale	1:10	Drawn	TAH
Checked	RC	Approved	RC
Date	09/06/20	Date	22/12/20
Date	22/12/20	Date	22/12/20
Drawing No.	777_TPE_V1_XX_DR_C_0721	Rev	T.3

0 10 20 30 40 50 60 70 80 90 100 Millimetres

A1

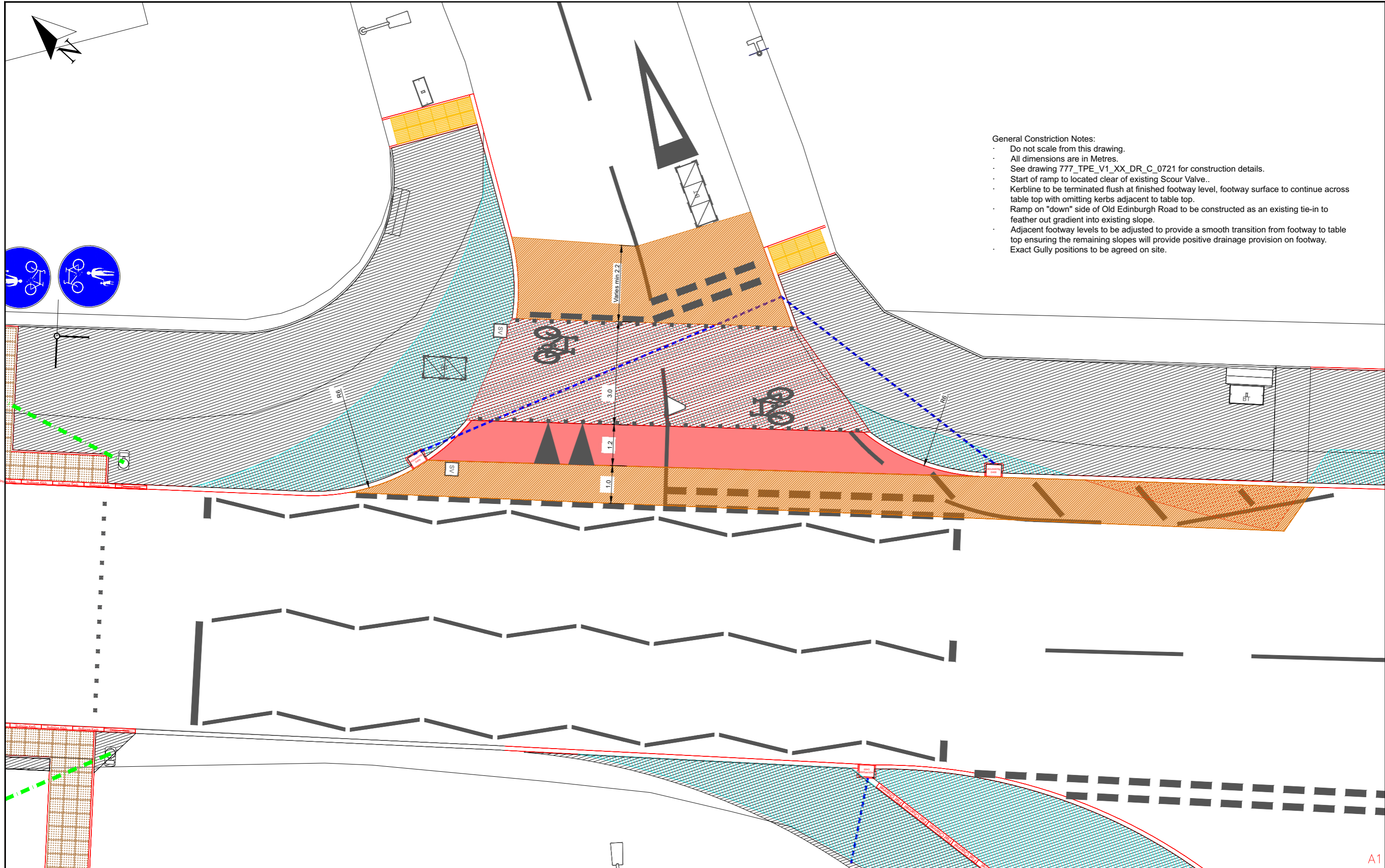

- General Construction Notes:**
- Do not scale from this drawing.
 - All dimensions are in Metres.
 - See drawing 777_TPE_V1_XX_DR_C_0721 for construction details.
 - Start of ramp to located clear of existing Scour Valve..
 - Kerline to be terminated flush at finished footway level, footway surface to continue across table top with omitting kerbs adjacent to table top.
 - Ramp on "down" side of Old Edinburgh Road to be constructed as an existing tie-in to feather out gradient into existing slope.
 - Adjacent footway levels to be adjusted to provide a smooth transition from footway to table top ensuring the remaining slopes will provide positive drainage provision on footway.
 - Exact Gully positions to be agreed on site.

Notes :

Series 1100: Footway and cycle construction

- Sub base 225mm
- Binder course 50mm
- Surface course 30mm

Series 700: Road Pavement 777_TPE_V1_XX_DR_C_0721

- 50mm binder course
- 40mm surface course
- Red thermo-plastic screed overlay.

Rev	Description	By	Date	Chk'd	Approved	Purpose of Issue
T.3	Supplementary service information added on DER	TAH	22/06/21	RC	22/06/21	The Road Hump/Scotland Reg. consultation
T.2	Notes updated to include Old Edinburgh Road variation	TAH	15/06/21	RC	15/06/21	The Road Hump/Scotland Reg. consultation
T	Tender Issue	TAH	25/02/21	RC	25/02/21	
A	Original Drawing					

Client

Perth and Kinross COUNTRYSIDE TRUST

TP&E
Transport Planning & Engineering

Project Bridge of Earn to Newburgh Phase 1A

Title Proposed Road Layout Road Pavement Layout – Old Edinburgh Road Junction

Scale 1:50

Drawn	Checked	Approved
TAH	RC	RC
Date 09/06/20	Date 22/12/20	Date 22/12/20

Drawing No. 777_TPE_V1_XX_DR_C_0722

Rev T.3

0
10
100
Millimetres

A1