

Schedule for Additions to the List of Public Roads

Town	Street Name	Construction Consent No.	Developer	Length	Ward	Street Lighting Columns	Remarks	Financial Implications	
								Roads	Street Lighting
Alyth	Isla Road	CC/PK/06/20	Cullochgold Services	30m	2	0		£674	£0
Auchterarder	St Serf's Place	CC/PK/08/08	DCT Civil Engineering	100m	7	5	Works completed by PKC having called in the bond	£2245	£325
Comrie	Camp Road	N/A	Perth and Kinross Council	173m	6	0	Part of the 2013 Flood Protection Works	£3884	£0
Dunning	Access Road leading to Rossie Steading	CC/PK/07/24	Countryside Steading Conversions	416m	7	0		£9339	£0
Greenloaning	Sheriffmuir Close	CC/PK/08/11	WHP Developments	115m	7	6		£2582	£390
Kinnesswood	Whitecraigs	CC/PKC/10/11	A & J Stephen	90m	8	3		£2021	£195
Perth	Bridge Lane	N/A	Perth and Kinross Council	N/A	12	0	Mill St Public Realm Improvements (Widening of footway 8m)	£30	£0
Perth	Burts Close	N/A	Perth and Kinross Council	80m	12	0	Mill St Public Realm Improvements	£299	£0
Perth	Mill Street including East and West Car Parks	N/A	Perth and Kinross Council	N/A	12	0	Mill St Public Realm Improvements (Widening of footway 130m)	£486	£0
TOTALS				1004m		14		£21,560	£910

Isla Road,
Alyth

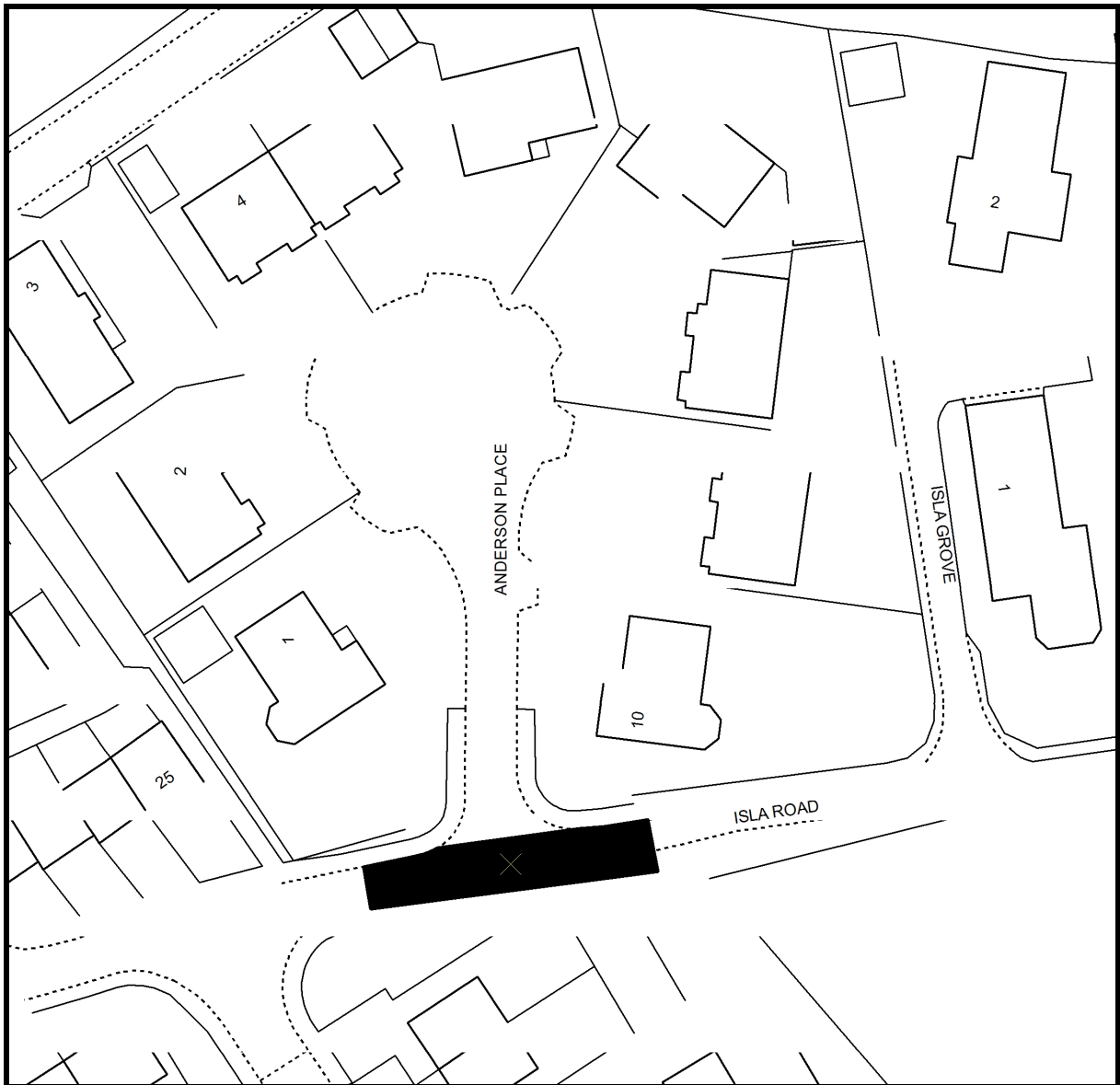

© Crown copyright [and database rights] 2017. OS 100016971. Use of this data is subject to terms and conditions.

St Serf's Place
Auchterarder

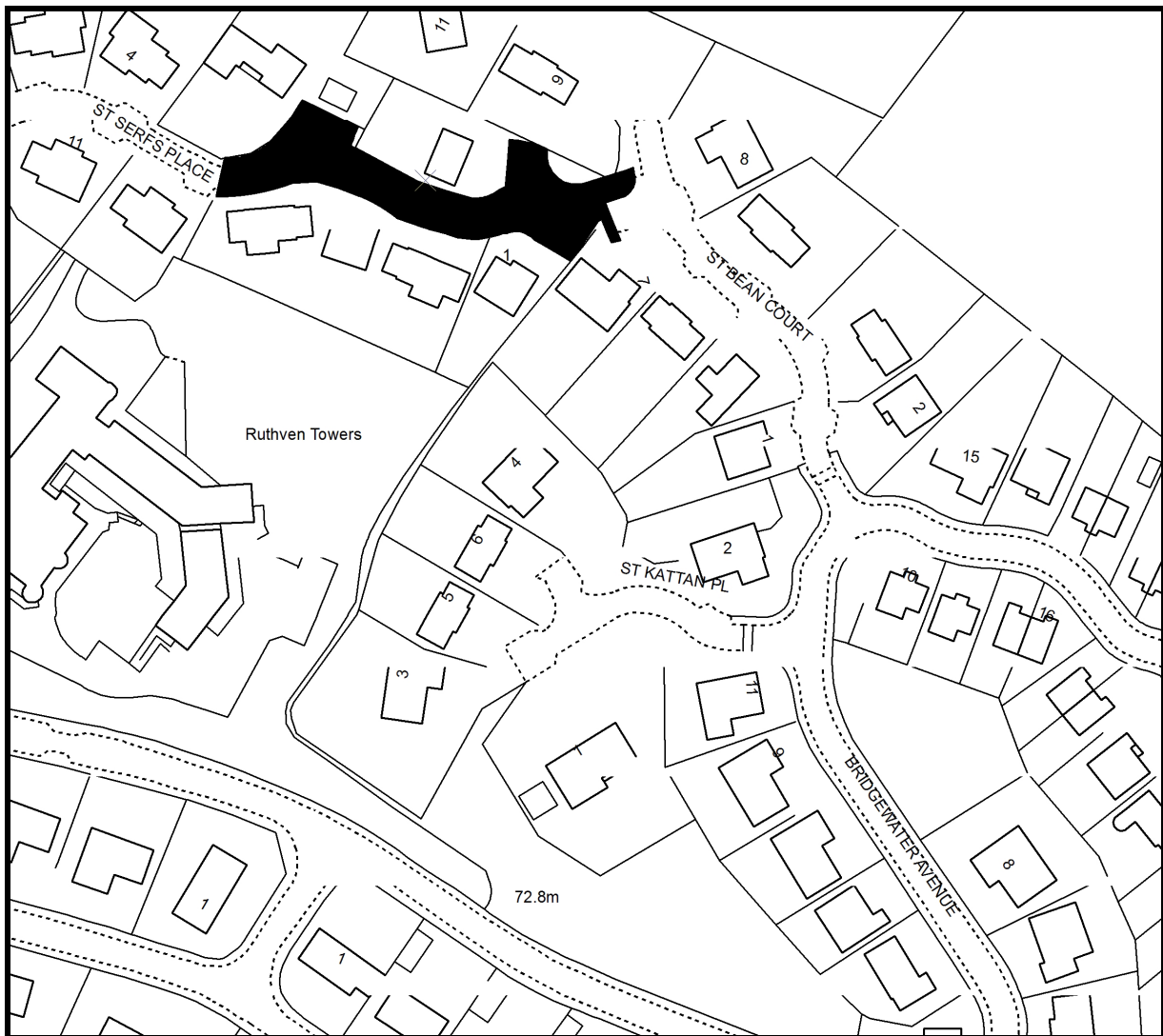

© Crown copyright [and database rights] 2017. OS 100016971. Use of this data is subject to terms and conditions.

Camp Road,
Comrie



© Crown copyright [and database rights] 2017. OS 100016971. Use of this data is subject to terms and conditions.

Access Road leading to Rossie Steading,
Dunning

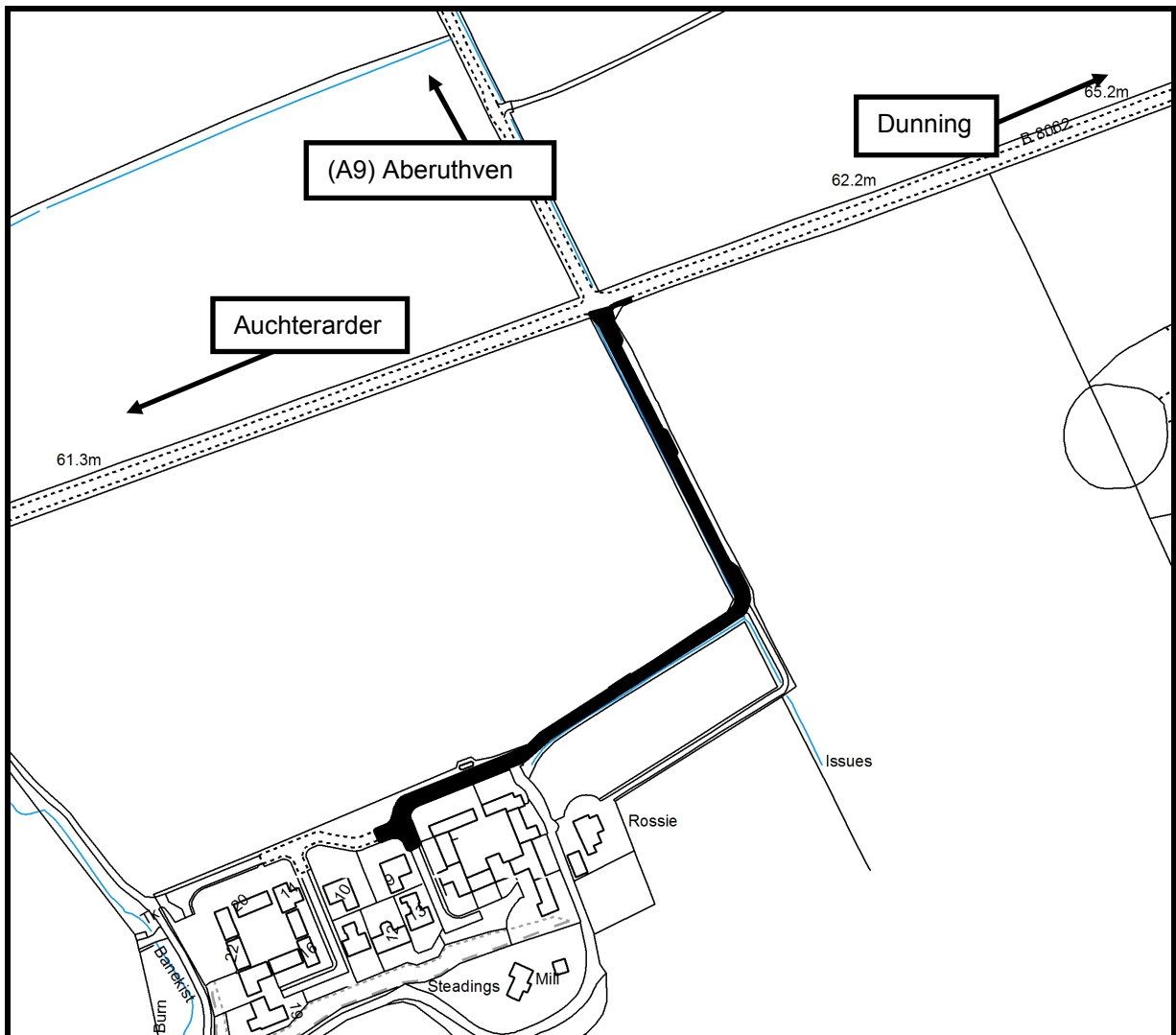

© Crown copyright [and database rights] 2017. OS 100016971. Use of this data is subject to terms and conditions.

Sheriffmuir Close,
Greenloaning

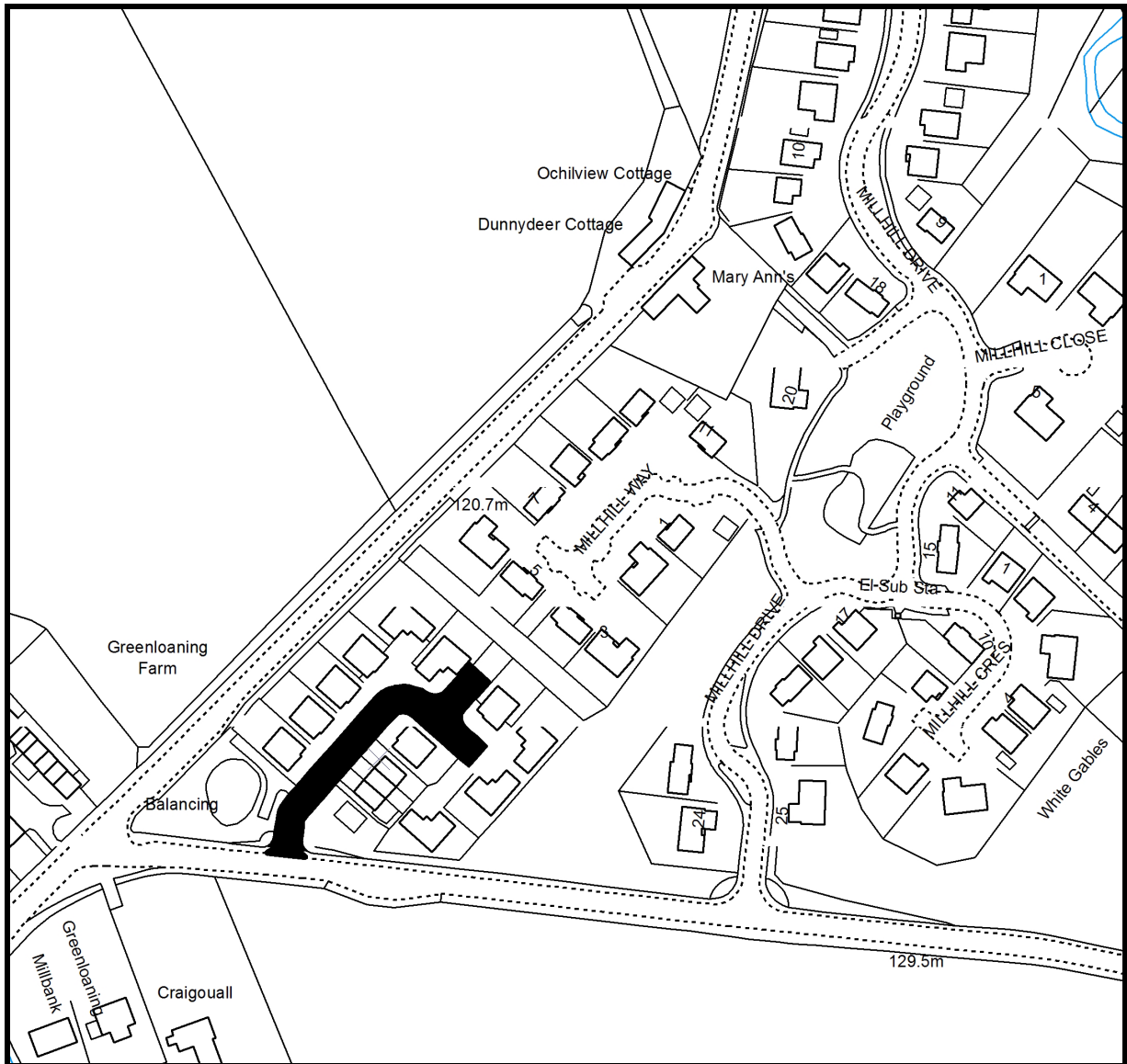

© Crown copyright [and database rights] 2017. OS 100016971. Use of this data is subject to terms and conditions.

Whitecraigs,
Kinnesswood



© Crown copyright [and database rights] 2017. OS 100016971. Use of this data is subject to terms and conditions.

Bridge Lane, Perth

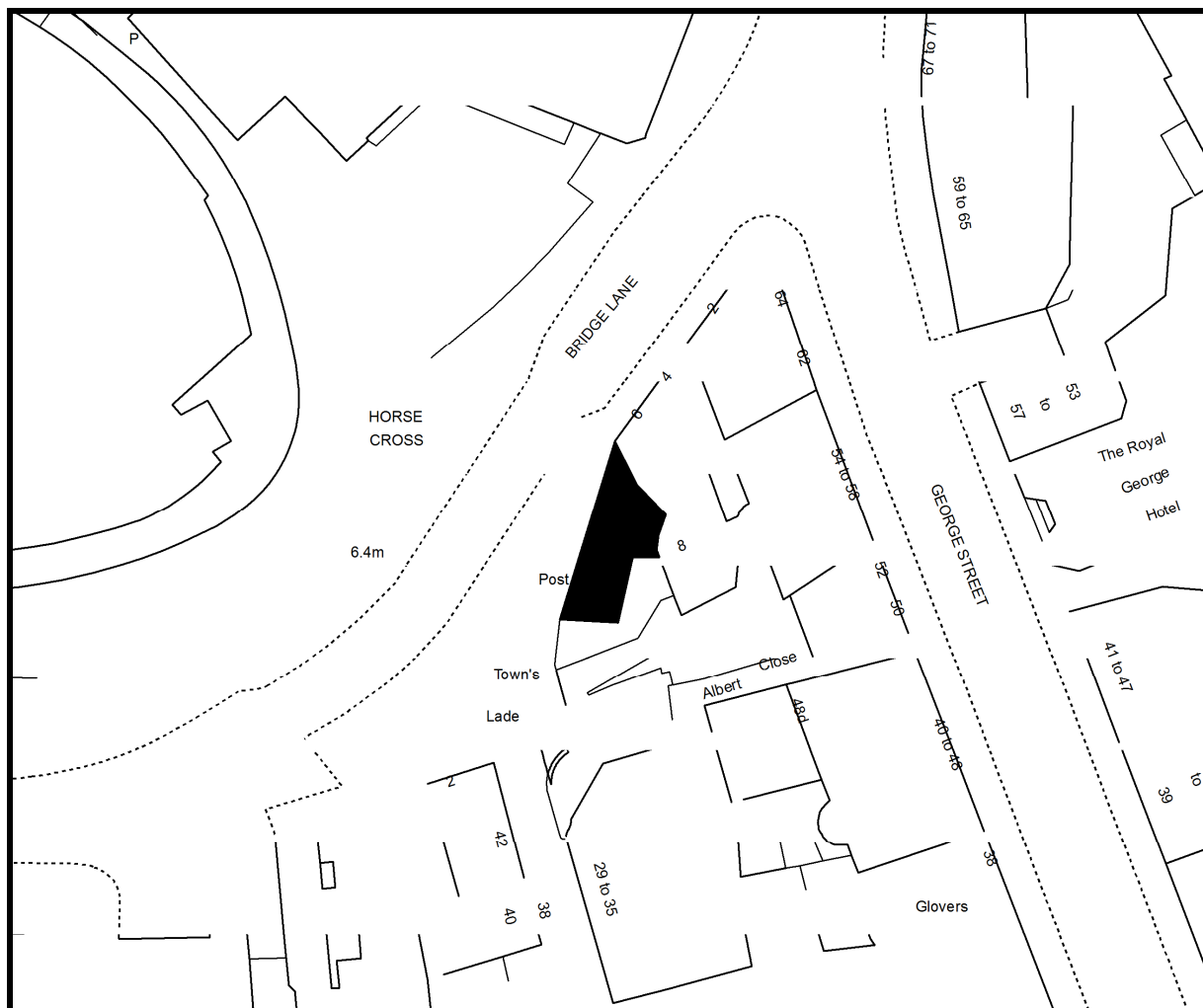

© Crown copyright [and database rights] 2017. OS 100016971. Use of this data is subject to terms and conditions.

Burts Close,
Perth

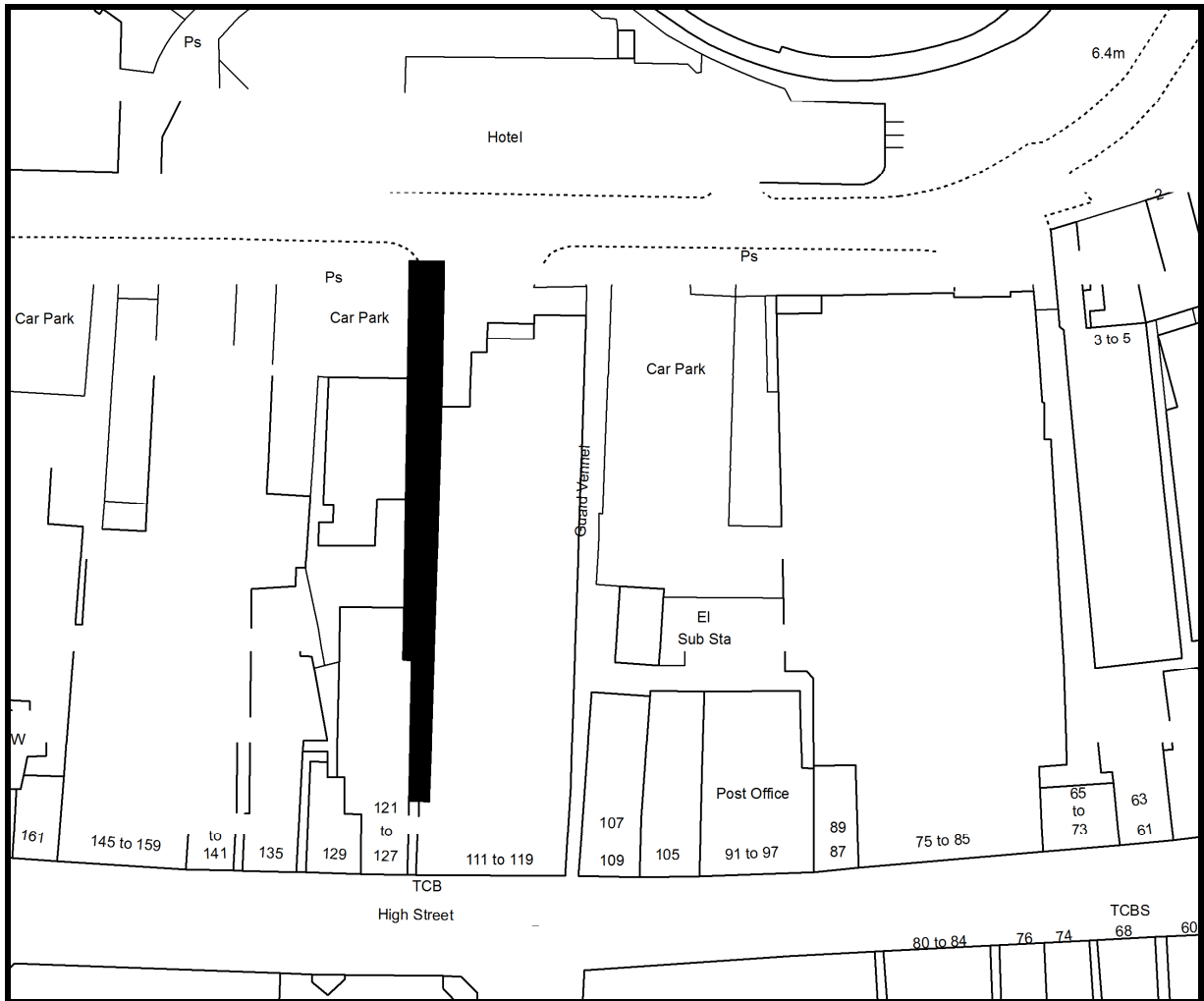

© Crown copyright [and database rights] 2017. OS 100016971. Use of this data is subject to terms and conditions.

© Crown copyright [and database rights] 2017. OS 100016971. Use of this data is subject to terms and conditions.